



**MOBILE RACKING  
SYSTEM**

 **compatta** Cargo



# Compatta Cargo. Making space more compact.



**COMPATTA CARGO**  
IS A SEMI-AUTOMATIC  
MOBILE SYSTEM  
FOR THE INTENSIVE  
STORAGE OF HEAVY  
AND BULKY LOADS.

## 1. Operation

# +80%

Increase in storage capacity.

# +40%

Of warehouse space freed up.

## Compact outside, big inside.



Conventional pallet racking system



Mobile racking system COMPATTA Cargo



**Compatta Cargo** consists of racking mounted on mobile bases which slide along guide rails. Access to stored material can be achieved by opening only the individual aisle in which the material is stored. This movement can be carried out remotely, with the warehouse operator using a mobile device, or can also be actioned by pressing the appropriate button on board the mobile base. Compatta Cargo **provides more than 80% of increased storage and can reduce the footprint of the warehouse by more than 40%** compared to more traditional static racking. This results in significant savings on the investments required for infrastructure, and on the time and costs involved in material handling.

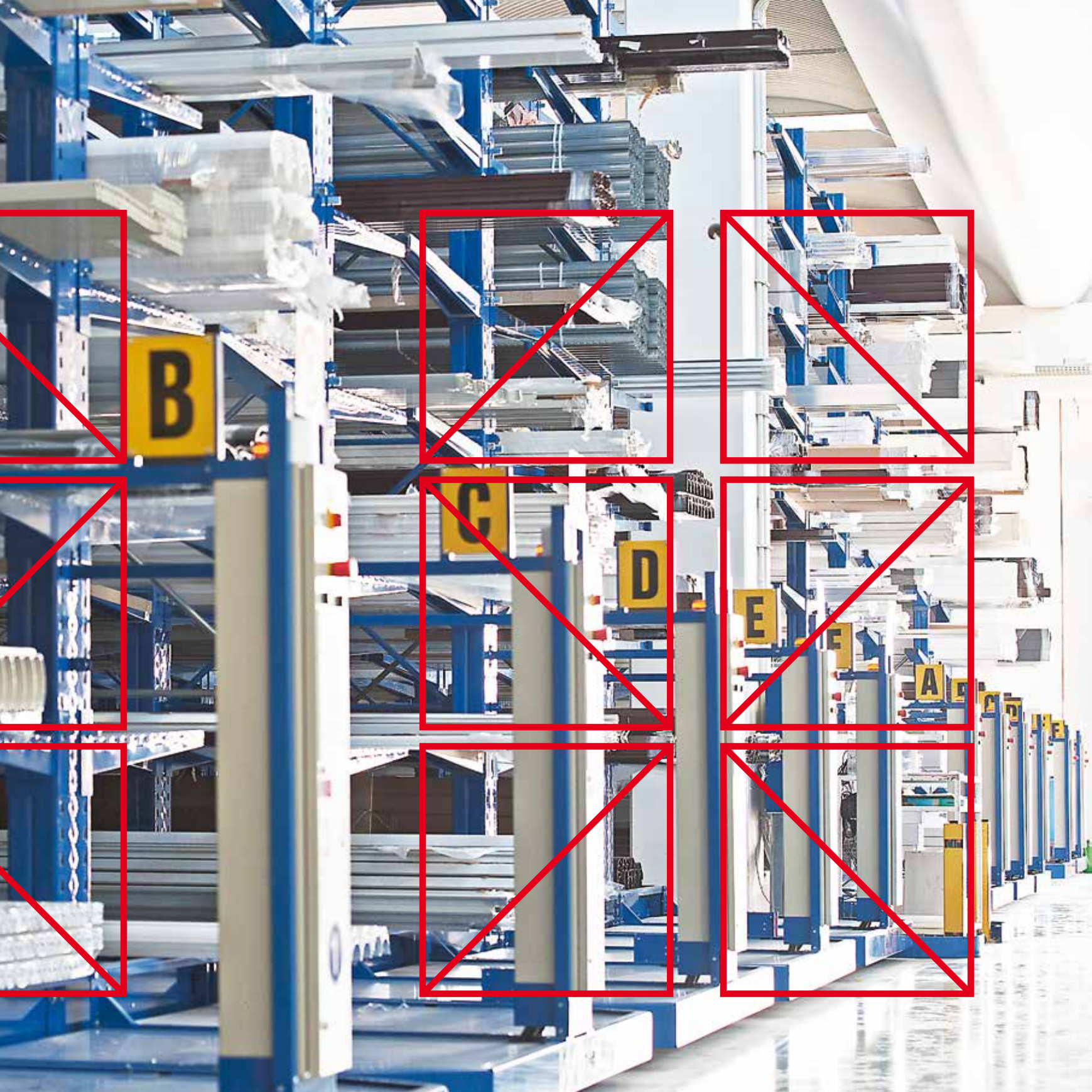

## 2. The benefits at a glance

---

# Compatta Cargo moves to meet your needs.



### 1. FUNCTIONAL

It allows you to **reduce the surface area occupied, or increase storage capacity.**



### 2. ADAPTABLE

It adapts to **every type of racking**, even reutilizing existing racking and can be adapted to suit **any environment.**



### 3. VERSATILE

Ideal for the storage of pallets and items of **different sizes and weights in normal, cold room or explosive material storage.**



### 4. EXPANDABLE

The modular design makes it simple to **add extra mobile bases** as required.



### 5. SUSTAINABLE

It **reduces energy costs**, especially in cold room environments.



### 6. AFFORDABLE

Excellent **capacity-to-cost** ratio and low maintenance costs.



### 7. RESISTANT

Increased **structural stability** using C45 steel for the heavier loads.



### 8. EARTHQUAKE-PROOF

The structure provides an **insulating effect** to the movement of the ground.



### 9. SIMPLE

**ICON™**, our web-based software simplifies the management and handling of the warehouse.



### 3. Applications

## Its ideal environment is your environment.



### Room temperature environments.

The need to make the best possible use of available space is a common thread across all sectors of industry. Compatta Cargo is the ideal solution for the intensive storage of **different kinds of material both in terms of size and weight**: beams, sheet metal, pipes, moulds, coils, panels, bins or rolls of fabric and so on.



### Cold room environments (up to -40° C).

Compatta Cargo is the perfect choice for cold room storage. From a stock point of view the volume of a cold room can be kept to a minimum, while for existing cold room environments storage capacity can be increased considerably. Both of these alternatives result in **reductions in energy consumption and environmental impact**.



### Explosive material environments.

This **flameproof** version of Compatta Cargo can be used to **reduce the risk of fires and explosions** through the use of electrical materials which conform to the regulatory standards (electrical panels, wiring, sensors, sirens, push button control panels and motors). In this way inflammable and explosive materials such as inks, paints and solvents can be stored more safely.

#### 4. The system components

# Three parts. One single solution.

The Compatta Cargo system is made up of three main elements: the mobile bases, the rails and the racking. The electrical system provides movement and control of the bases.

## The mobile bases.

The mobile bases, which allow handling of the racking, are designed according to the size and weight of the unit load. Movement of the mobile bases is managed and controlled by inverters which enable the mobile racking to start and stop movement gradually, ensuring any sudden and dangerous jerks can be avoided. The mobile bases **can even be installed in premises with support pillars, as the bases can be cut down to ensure that the columns do not impede handling.**

From **3,500 kg**  
to **12,000 kg**

The load-bearing weight for each wheel, depending on the model.

**1,000 t**

Total maximum load

**70 m**  
Maximum length of the mobile bases.

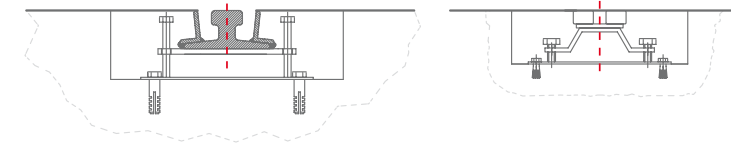

1. The **guide rails** ensure that the entire base stays perfectly aligned during movement.

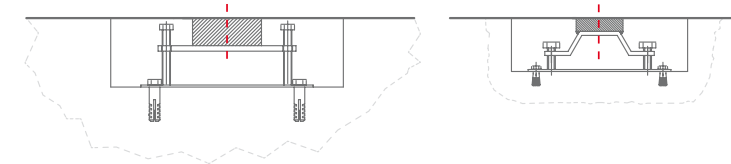

2. The **running rails** help the mobile base wheels to move easily.

## The rails.

Each system has at least **two guide rails and one or more runner rails** whose size depends on the load the mobile bases have to carry. During construction of the warehouse, the rails are fixed directly into the concrete screed; in pre-existing premises, however, the floor will have to be cut to insert the rails or alternatively the rails will be fixed above floor level and the surrounding floor will have to in-filled around them to ensure that in either case the rails are perfectly level with the final floor level.



## The racking.

With its extremely versatile mobile bases Compatta Cargo can store **any type of material**, on any type of racking, even pre-existing racks for **pallets or containers, cantilever racking for long materials or sheet metal**. It can also be fitted with shelving for small parts and bulk material or racking for coils. Stackable bins can be stacked directly onto the mobile bases. It is also possible to convert pre-existing fixed racking into mobile systems. Each system consists of two fixed



racking uprights, either single or dual access, and a variable number of mobile shelving units which are always double faced.

The racking load levels are designed to suit the available height in the premises and the characteristics of the load units to be stored (size and load bearing capacity).

## The Electrical Handling System.

The electrical system is responsible for the handling and control of the mobile bases, both individually and in sequential logic. The system is **made up of a main electrical switchboard**, located outside the area controlled by the system's safety light curtain, which is connected via an innovative digital data transmission line to the **peripheral**

**switchboards** located on the front of each mobile base, where the system handling buttons are located. In systems where handling will be carried out by remote control, a **radio control unit** is located on the rear of the mobile system.



5. Safety measures

# Leaving room for safety.

Both your stock and your operators are safe with Compatta Cargo. The system is equipped with a **safety light curtain** on the front access of the mobile racking which controls both the entry and exit of every warehouse operator. If an obstacle is detected inside the access aisle additional photoelectric cells, positioned along the mobile base, immediately halt movement.

The operator is, however, always required to give consent to any handling operation by pushing the appropriate button, located either on the main electrical switchboard or on the switchboards on board every mobile base. To complete the range of safety devices, **flashing warning lights and sirens** signal that the system is in movement.



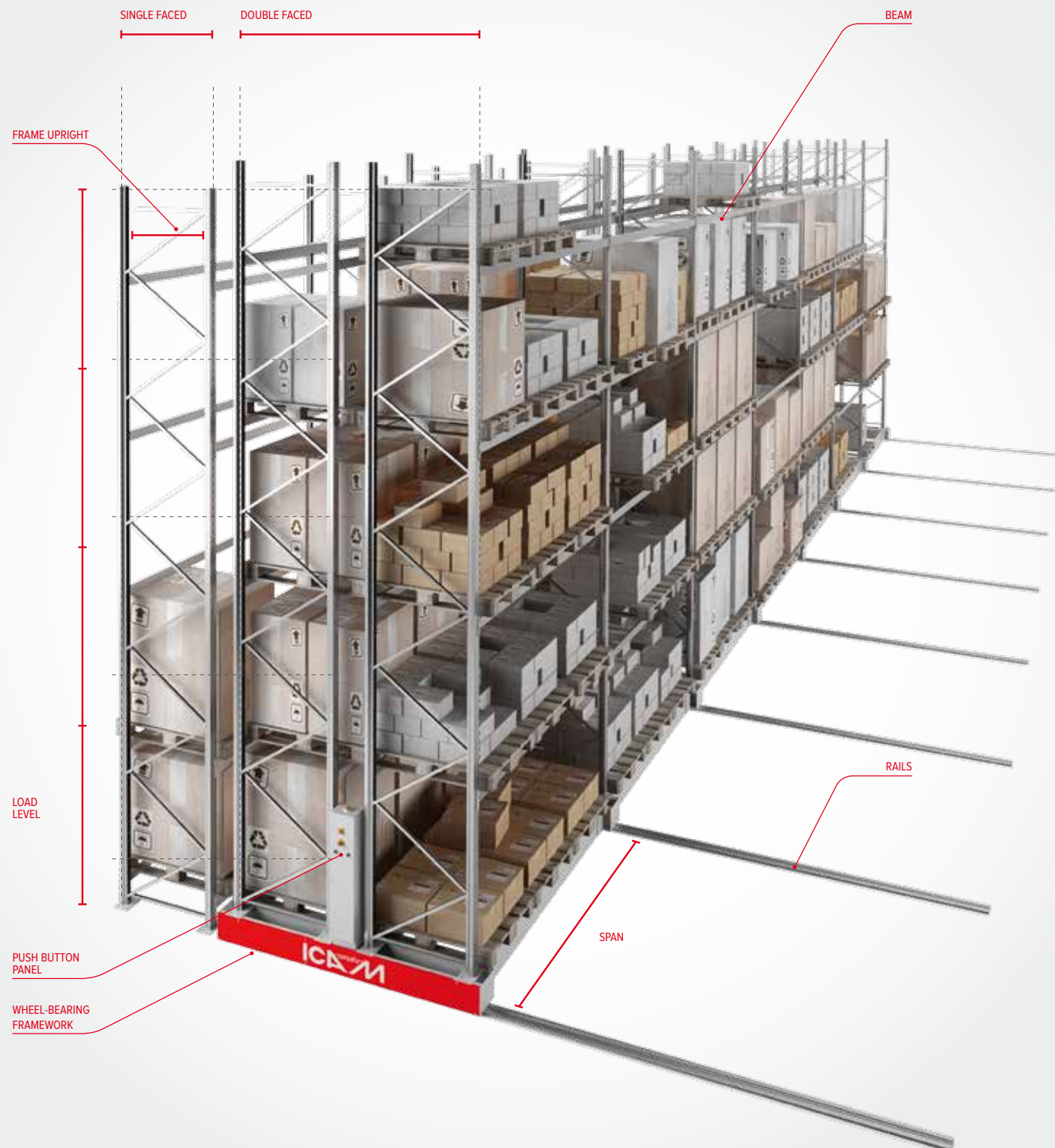

## 6. Technical characteristics

# Some numbers for you.



## DIMENSIONS

> Minimum/Maximum width of mobile bases:

**650/6,100** mm

> Minimum/Maximum length of mobile bases:

**2,000/70,000** mm

> Height of 1<sup>st</sup> loading level:

**269/278** mm

> Maximum total height of the racking:

**12,000** mm



## LOAD-BEARING CAPACITY PER SPAN

> Minimum load-bearing capacity:

**7,000** kg

> Maximum load-bearing capacity:

**48,000** kg



## SPEED

> Speed of movement:

**0.06/0.12** m/s

## 7. Optional extras

# Features to improve efficiency.

Each installation has its own specific requirements. To meet the diverse needs of our clients Compatta Cargo provides a range of tools and optional features that enhance its use, such as the **Relax, Lux** and **Picking systems**.



### RELAX

This option offers the possibility **to programme the aisles to open at evenly spaced intervals from each other** when the system is not being used. This can aid the circulation of air in cold room environments or help with the distribution of water in sprinkler systems in the case of fire in inflammable materials.

### LUX

This option helps **reduce energy consumption** by automatically turning on the lights only in the relevant aisle.



### PICKING

This system **allows picking times to be reduced** by opening and giving access to more than one aisle at a time.

## 8. Computerized warehouse management

# The warehouse moves with you, from a distance.

Manage your warehouse simply and safely while reducing waiting times. The use of radio control units allows you to **open the desired aisle without having to get out of the forklift truck**. You can also activate Relax, Lux and Picking optional features by simply pushing a button.

Furthermore, management and control of COMPATTA Cargo system are made possible thanks to **ICON™**, the multi device and multi- language web-based software, entirely designed and developed by ICAM. It runs across PCs, Tablets and Smartphones.

**ICON™ enables the management of the entire range of ICAM storage systems**, providing greater flexibility, being interfaceable with the most popular **WMS** and **ERP** management software. Its intuitive graphical interface helps making storage and retrieval operations easier for the warehouse operators by indicating which storage location to retrieve goods from and suggesting the

empty locations available. **ICON™** also provides an overview of the main data of your warehouse with real time information about possible errors of the system. In addition **barcode readers** and **RFID** allow the stock to be **updated in real time** simplifying warehouse operations.

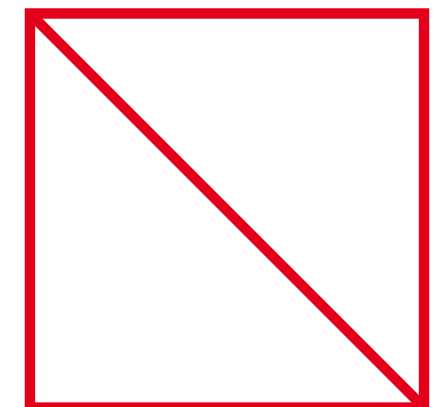



# ICAM

INTELLIGENT SPACE SOLUTIONS

[compattacargo.com](http://compattacargo.com)



ICAM srl - S.P. 237 delle Grotte - 70017 Putignano (Ba), Italy - P.O. Box 129  
Ph. +39 080 4911377 - Fax +39 080 4911529 - [info@icamonline.eu](mailto:info@icamonline.eu)

